

First Implantation with K3Pro®

● Removal of the implant from the packaging / container

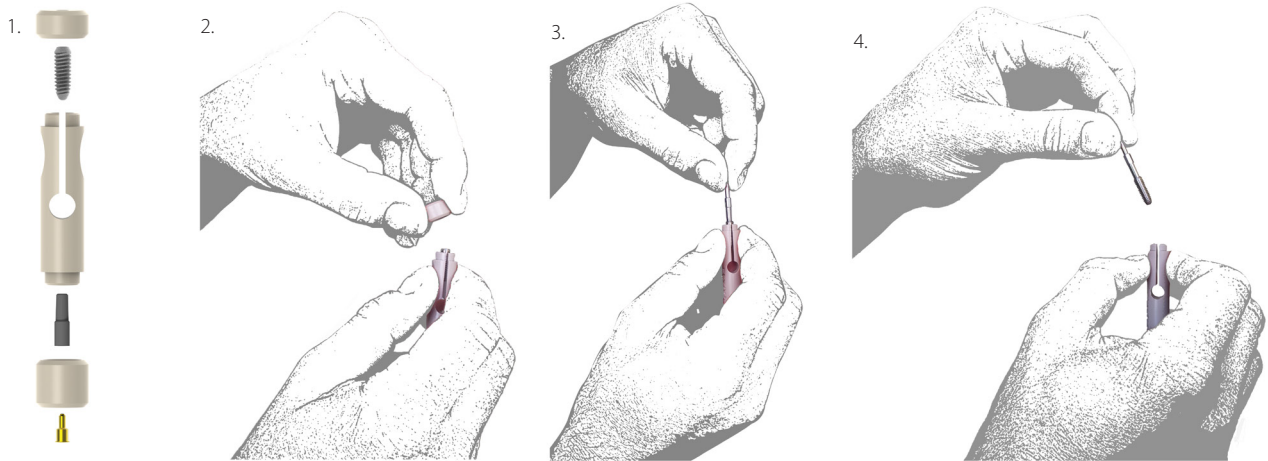

1. Implant, held through the container made of PEEK. The locking screw is located at the bottom.
2. Access to the implant well is made by removing the cover screw cap.
3. To hold the implant for fixation of the insertion instrument; press the container together when fixing and release when removing the implant for insertion.
4. Release and removal of implant is possible when the implant and insertion instrument have a light conical fixation. Insure that the implant level marking on the insertion instrument is disappeared.

● Insertion Torque prosthetics

		2 mm	3 mm	Short	
		2 mm	3 mm	Short	
Abutment Screws		20 Ncm	30 Ncm	20 Ncm	
Screws (open and closed) for Transfers		10 Ncm	15 Ncm	10 Ncm	
Provisional Abutments (PA)		10 Ncm	15 Ncm	10 Ncm	
Gingivaformer (TA)	Titanium	10 Ncm	15 Ncm	10 Ncm	
	Peek	10 Ncm	15 Ncm	10 Ncm	
Locator / O-Ring Abutments (FLA / KKA)		20 Ncm	30 Ncm	20 Ncm	
Bar Base Abutments (SBA)		20 Ncm	30 Ncm	20 Ncm	
Multibase Abutments (MB)		20 Ncm	30 Ncm	20 Ncm	
RapidFix Abutments (VBA)		20 Ncm	30 Ncm	20 Ncm	
	secondary screw	10 Ncm	10 Ncm	10 Ncm	

K3Pro® Surgical Protocol for low to high drilling speed

Diameter	Round Bur	Starter Drill	crestal Pilot Drill 2,0 mm	sub-crestal Pilot Drill 2,5 mm	Implant Drill (Surgical Steel) Replacement after 50 applications is recommended						Tap	Sinker	Implant Inserters	Cover Screws	Platform
					ø 3,0 mm	ø 3,5 mm	ø 4,0 mm	ø 4,5 mm	ø 5,0 mm	ø 6,0 mm					
	800 U/min	800 U/min	600 U/min	600 U/min	50 - 600 U/min	50 - 600 U/min	50 - 600 U/min	50 - 600 U/min	50 - 600 U/min	50 - 600 U/min	20 U/min 45 Ncm	50 U/min 35 Ncm	2mm Platform: 20-25 Ncm 3mm/Short Platform: 20 - 35 Ncm	5 Ncm	
Ø 3,0															
	KB1.9K	KB.STLD	KB2.0/ LengthS	KB2.5/ LengthS	Sure / Short: KKB3.0/18.00S Rapid: KKB3.0/18.00S						GS_3.0	K_3.0	WSEL_1.4	VSK2K	
Ø 3,5															
	KB1.9K	KB.STLD	KB2.0/ LengthS	KB2.5/ LengthS	Sure / Short: KKB3.0/18.00S Rapid: KKB3.0/18.00S	Sure / Short: KKB3.5/18.00S Rapid: KKB3.5/18.00S					GS_3.5	K_3.5	WSEL_1.4	VSK2K	
Ø 4,0															
	KB1.9K	KB.STLD	KB2.0/ LengthS	KB2.5/ LengthS	Sure / Short: KKB3.0/18.00S Rapid: KKB3.0/18.00S	Sure / Short: KKB3.5/18.00S Rapid: KKB3.5/18.00S	Sure / Short: KKB4.0/18.00S Rapid: KKB4.0/18.00S				GS_4.0	K_4.0	WSEL_1.6	VSK3K_S	
Ø 4,5															
	KB1.9K	KB.STLD	KB2.0/ LengthS	KB2.5/ LengthS	Sure / Short: KKB3.0/18.00S Rapid: KKB3.0/18.00S	Sure / Short: KKB3.5/18.00S Rapid: KKB3.5/18.00S	Sure / Short: KKB4.0/18.00S Rapid: KKB4.0/18.00S	Sure / Short: KKB4.5/18.00S Rapid: KKB4.5/18.00S			GS_4.5	K_4.5	WSEL_1.6	VSK3K_S	
Ø 5,0															
	KB1.9K	KB.STLD	KB2.0/ LengthS	KB2.5/ LengthS	Sure / Short: KKB3.0/18.00S Rapid: KKB3.0/18.00S	Sure / Short: KKB3.5/18.00S Rapid: KKB3.5/18.00S	Sure / Short: KKB4.0/18.00S Rapid: KKB4.0/18.00S	Sure / Short: KKB4.5/18.00S Rapid: KKB4.5/18.00S	Sure / Short: KKB5.0/18.00S Rapid: KKB5.0/18.00S	Sure / Short: KKB6.0/12.00S Rapid: KKB6.0/12.00S	GS_5.0	K_5.0	WSEL_1.6	VSK3K_S	
Ø 6,0															
	KB1.9K	KB.STLD	KB2.0/ LengthS	KB2.5/ LengthS	Sure / Short: KKB3.0/18.00S Rapid: KKB3.0/18.00S	Sure / Short: KKB3.5/18.00S Rapid: KKB3.5/18.00S	Sure / Short: KKB4.0/18.00S Rapid: KKB4.0/18.00S	Sure / Short: KKB4.5/18.00S Rapid: KKB4.5/18.00S	Sure / Short: KKB5.0/18.00S Rapid: KKB5.0/18.00S	Sure / Short: KKB6.0/12.00S Rapid: KKB6.0/12.00S	GS_6.0	K_6.0	WSEL_1.6	VSK3K_S	